

**Material**

- Housing** : Polyamide (PA6 GFR30), black  
Zinc die, chrome plated or  
black coated
- Nut** : Plastic or Zinc die, zinc plated
- Cam** : Plastic or Zinc die, zinc plated

**Options**

**Cams** : Page 84-85

**Cut out**

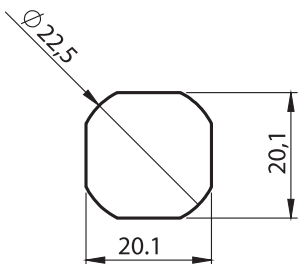

**1001 - Quarter Turn with Cylinder GH=18**

	PA	Zinc Die Chrome Plated	Zinc Die Black Coated
Keyed 3333	1001 - 900 - xxx	1011 - 910 - xxx	1011 - 920 - xxx
Keyed Same	1001 - 907 - xxx	1011 - 917 - xxx	1011 - 927 - xxx
Keyed Differ	1001 - 909 - xxx	1011 - 919 - xxx	1011 - 929 - xxx
Keyed Differ with Master Key	1001 - 908 - xxx	1011 - 918 - xxx	1011 - 928 - xxx

You may chose XXX section from cam tables

IP 44



LH/RH

RoHS