



Quarter Turns

Material

- Housing** : Zinc die, chrome plated or black coated
- Insert** : Zinc die, chrome plated or black coated
- Nut** : Zinc die, zinc plated

Options

- Cams** : Page 84-85
- Keys** : Page 45

Cut out

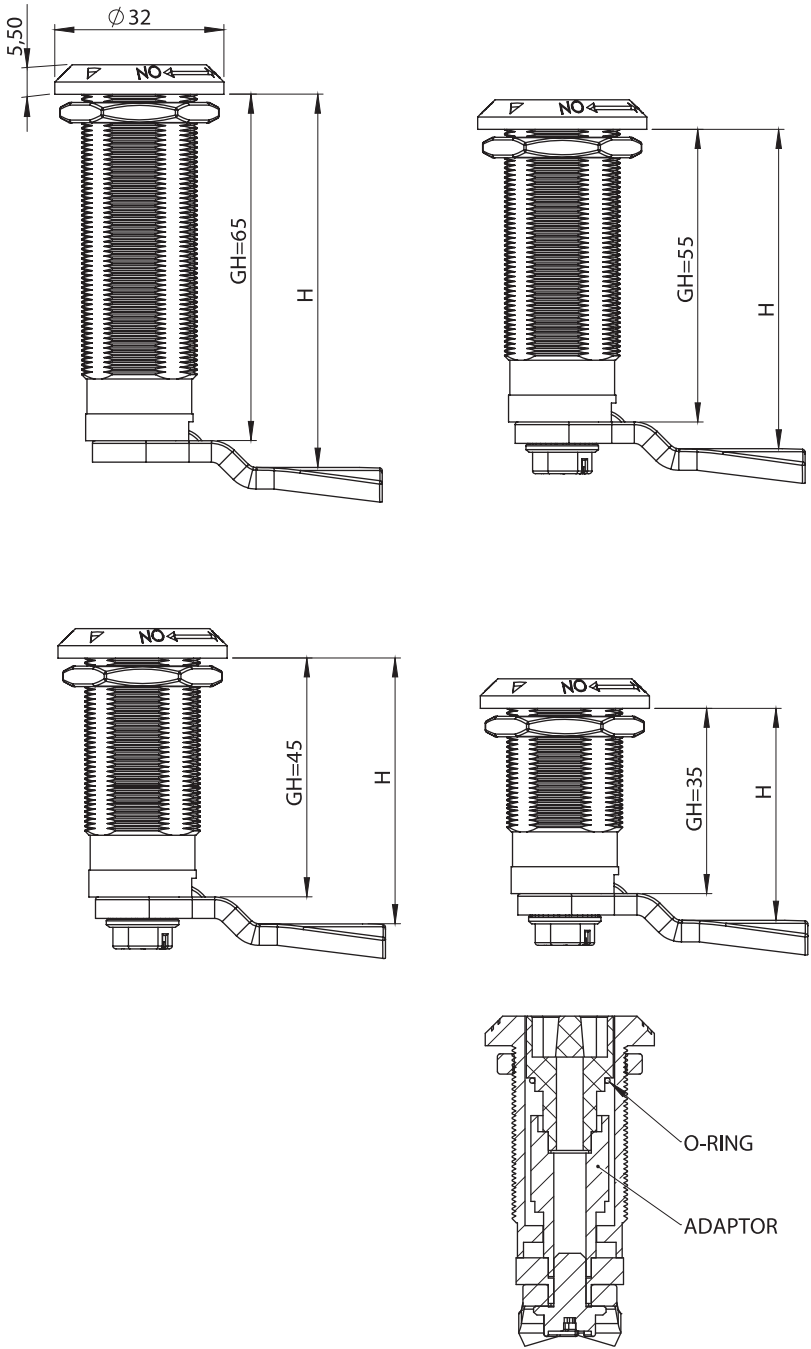
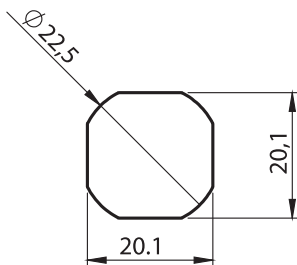

1120 - Quarter Turn

	Insert Types	GH=35	GH=45	GH=55	GH=65
	Double Bit 3 mm	1123 - 201 - xxx	1124 - 201 - xxx	1125 - 201 - xxx	1126 - 201 - xxx
	Double Bit 5 mm	1123 - 202 - xxx	1124 - 202 - xxx	1125 - 202 - xxx	1126 - 202 - xxx
	Triangular 8 mm	1123 - 203 - xxx	1124 - 203 - xxx	1125 - 203 - xxx	1126 - 203 - xxx
	Triangular 9 mm	1123 - 209 - xxx	1124 - 209 - xxx	1125 - 209 - xxx	1126 - 209 - xxx
	Square 7 mm	1123 - 204 - xxx	1124 - 204 - xxx	1125 - 204 - xxx	1126 - 204 - xxx
	Square 8 mm	1123 - 205 - xxx	1124 - 205 - xxx	1125 - 205 - xxx	1126 - 205 - xxx
	Slotted	1123 - 208 - xxx	1124 - 208 - xxx	1125 - 208 - xxx	1126 - 208 - xxx
	Eastern Europe	1123 - 210 - xxx	1124 - 210 - xxx	1125 - 210 - xxx	1126 - 210 - xxx

You may chose XXX section from cam tables

IP 65



LH/RH

RoHS